



As a global enterprise, HSG sticks to providing professional and convenient service support to customers at home and board

- Professional Training**
Multiple technical training service and free operation training for customers and dealers in time
- Efficient Support**
Humanistic service model, online services and 7*24 hotline to offer solutions and assistance
- Optimized Transport**
Multi-channel transport solutions and professional transport solution team will provide various transport cases for to satisfy the demand of customers and save transports fees
- Sufficient Accessories**
Highly efficient accessories delivery service, multiple network inventory jointly responds to accessories demand to shorten customer's waiting times and accelerate production
- Careful Services**
Domestic door-to-door service and free proofing, global 100+dealers provide efficient and convenient services

HSG
Shape Metal, Shape Trust



Website



Facebook



Youtube

Headquarters Add.: No. 4, Anye Road, Shunde District, Foshan, Guangdong, China
Website: www.hsglaser.com
Email: info@hsglaser.com
Tel:+86 757-66833906

HSG

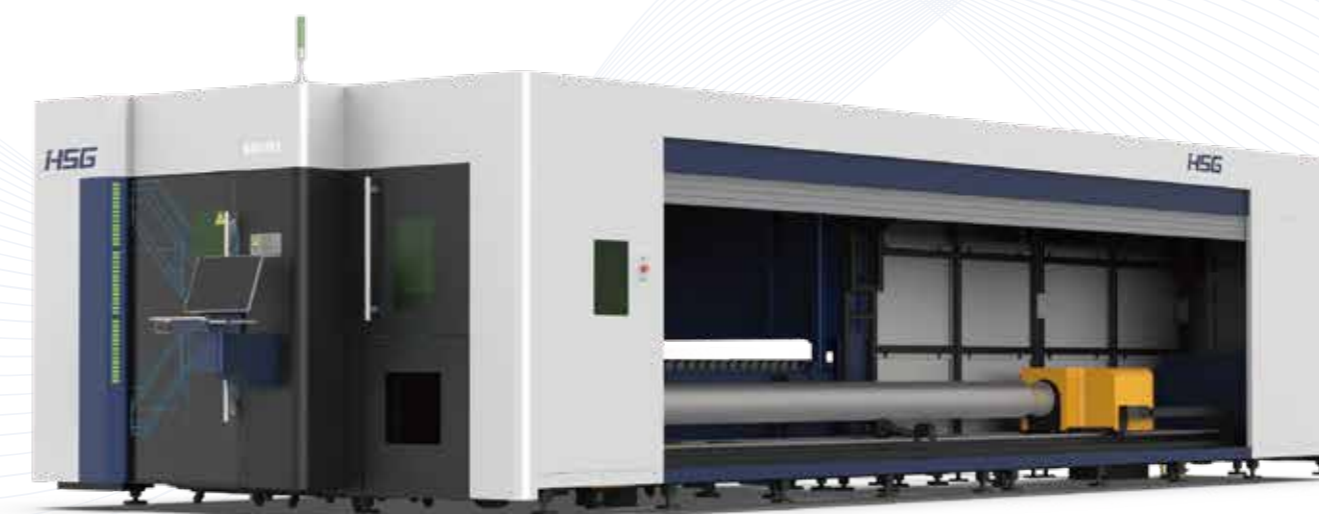

GXE-QBW

Double Exchange Platforms Sheet & Tube Laser Cutting Machine

www.hsglaser.com

Company Culture

- SLOGAN**
Shape Metal, Shape Trust
- MISSION**
To support the high-speed growth of our customers
- VISION**
To be a world-leading provider of metal shaping equipments & comprehensive solutions

Company Profile

19 Global Branches	100+ Countries Covered	5 Manufacturing Bases	30+ Global Service Centers
8,000+ Annual Capability	135,000m² Occupied Area		

GXE-QBW 1500-6000W

Double Exchange Platforms Sheet & Tube Laser Cutting Machine

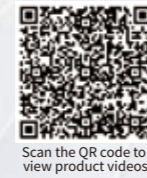
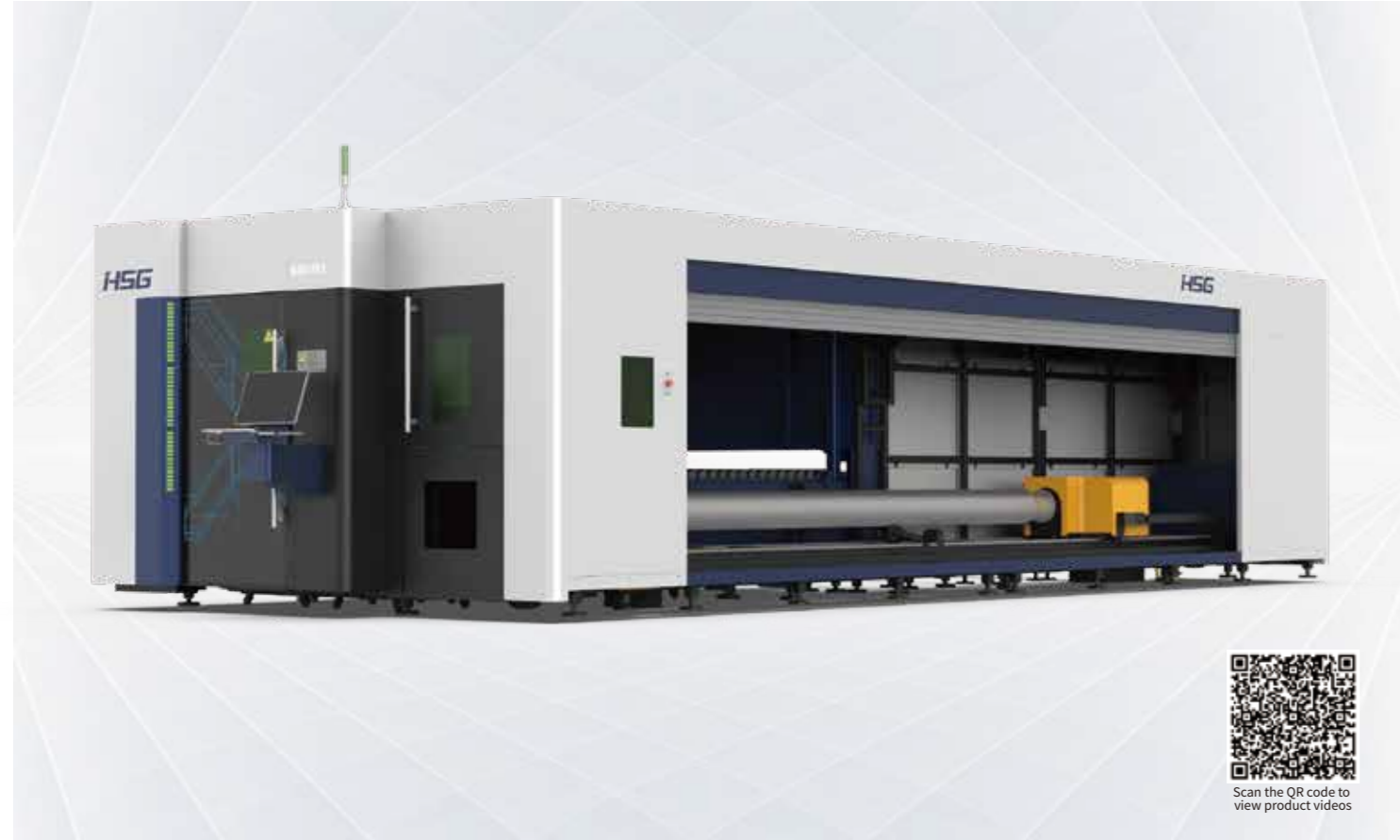

Scan the QR code to view product videos

HSG Bus-based Control System

- This system is easy to be operated and rich in functions.
- Even green hands can cut high-quality samples.
- Monitor core components in real time.
- Millisecond-level follow-up response technology.
- Click to create processing report.
- Compatible with codes of international brands.



Exchange Platforms

- Achieve the cutting operation and loading and unloading synchronization.
- Before the switching motor, the rear workbench loading and unloading space is sufficient.
- The sheet metal cover is safe from damage.



Automatic Focus Cutting Head

- Autofocus Laser Cutting Head
The cutting head can adjust its focus according to laser beam mode to make sure of mirror-like surface.
- Servo autofocus system
- Automatic cooling and obstacle avoidance
- Three built-in protective lens
- Anti-pollution design
- Give early warning if abnormal

Tube Splicing Technology

- The operating control offers 50+ kinds of tube splicing patterns, for convenience of subsequent welding, such as splicing of male and female head of square tube, 90° arc splicing, splicing of round tube tee, splicing of cut-through holes, 45° splicing of hexagon, splicing of angle iron and channel steel, etc.



Machine Foundation

*The marked size has about 10mm error

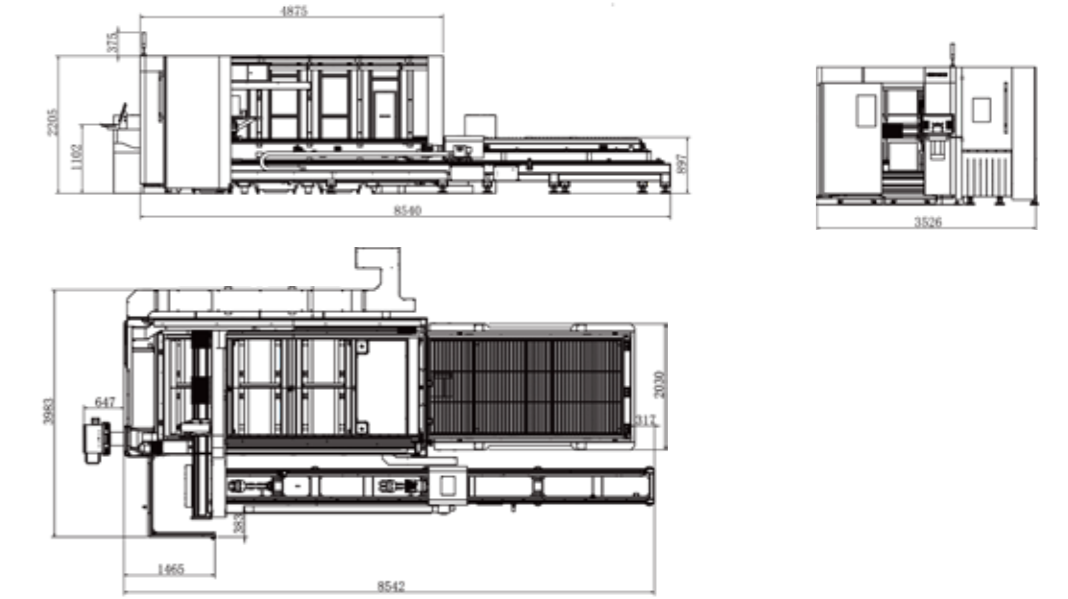

Cutting Samples

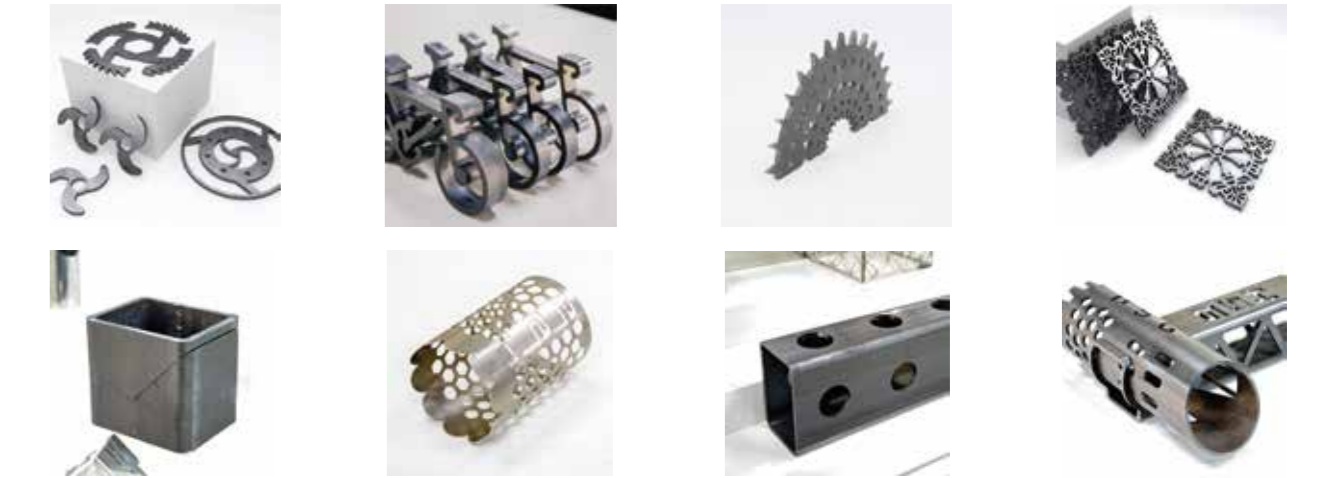

Cutting Capacity

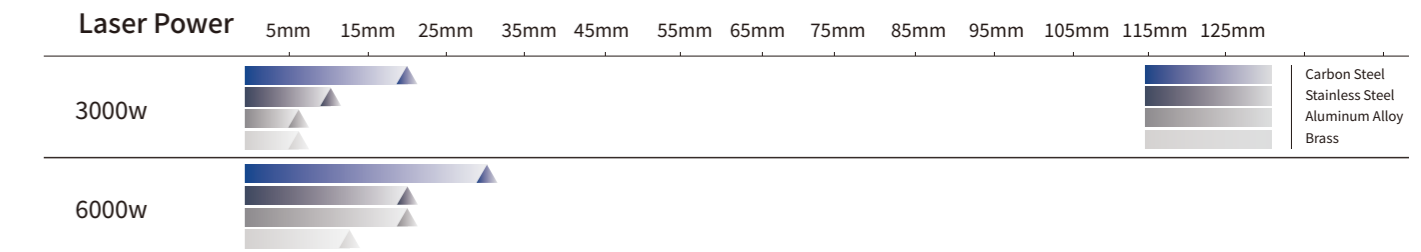

The actual machines shall prevail and above data & pictures are only for reference.

Technical Parameters

Technical Parameters	G3015XE
Power	1500W-6000W
Processing format (L*W)	3048mm*1524mm
X/Y-axis positioning accuracy	±0.03mm/m
X/Y-axis repositioning accuracy	±0.03mm
Max. Linkage Acceleration	0.5G
Max. Linkage Speed	60m/min

* Machine appearance, technical parameters, function description, data comparison shown in this page are from HSG in-house laboratory. All testing results and experimental data shall be subject to real machine.

Professional Nesting Software (Optional)

- No matter sheet cutting or tube cutting, it is equipped with professional nesting software to optimize cutting track and improve efficiency.



Automatic Pneumatic Double Chucks

- Automatic centering the chucks.
- Pneumatic chuck clamping with large clamping force.
- Special support frame to avoid tube sagging deformation.